

## STRIP LED DOT FREE MANUAL USER

# P Type

TOP EMITTING  
FOURSQUARE SURFACE



Foursquare structure surface, dot-free illumination, hollow air layer inside design, good heat dissipation.

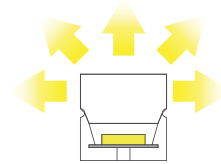

**150° beam angle.**  
Dot-free illumination

### Product Features:

- 150° Beam angle. 3 Side Emitting
- Good Visibility
- IP65/67 Waterproof
- 7 LEDs per unit Dot-free
- Dual color of silicone
- Hollow air layer for good heat dissipation

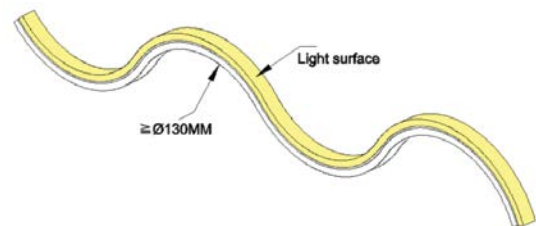

### Applications:



## 150° BEAM ANGLE & THICK PROTECTION

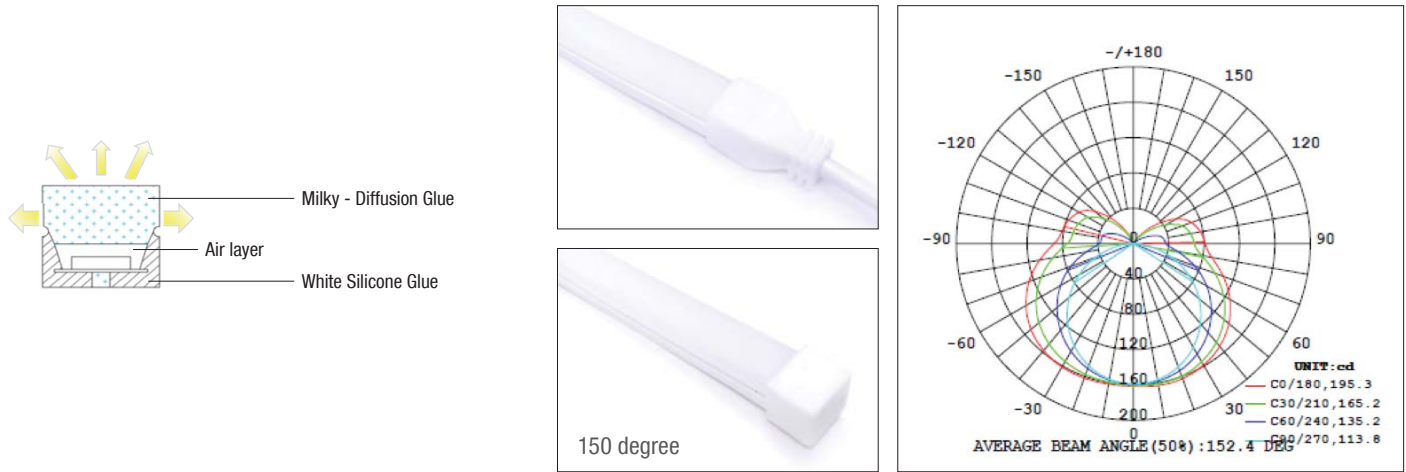

Silicone coating, UV Resistant, Yellowing Resistant, Flame Resistant. Include 5M constant voltage and 10M constant current versions.

## VISIBILITY & FLEXIBILITY

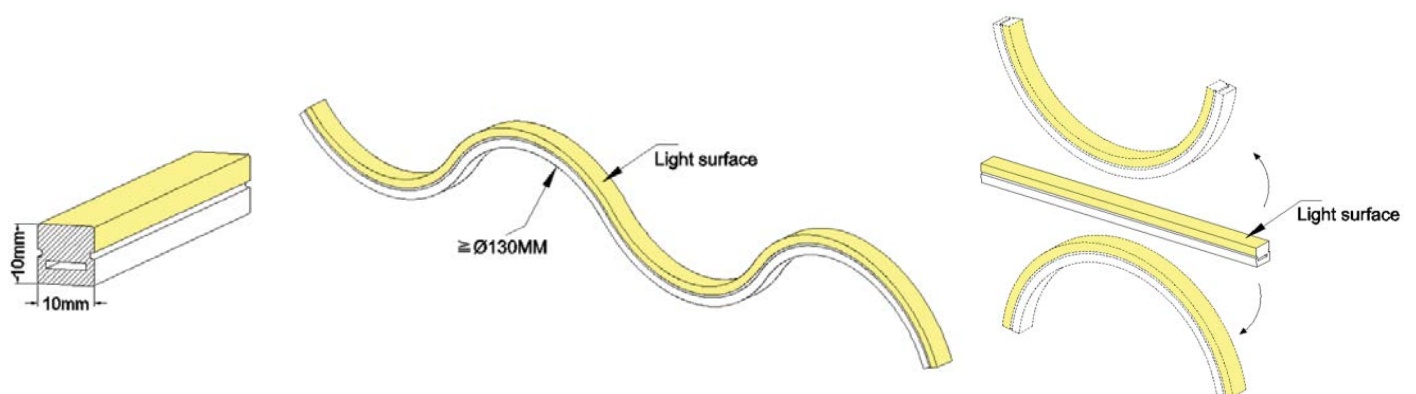

Top emitting, bendable direction vertically and minimum bending diameter for 130mm.

## NEW FPC STRUCTURE

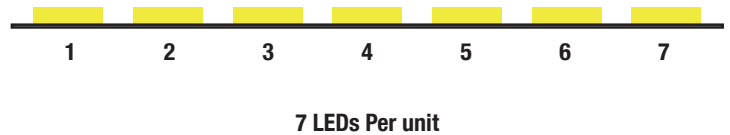
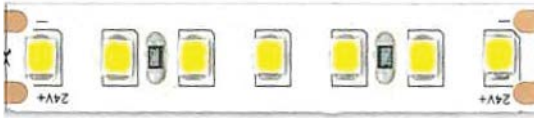

7 LEDs per unit LED strip used as lighting source, higher lumen output than general Neon Flex.

## DIMENSION

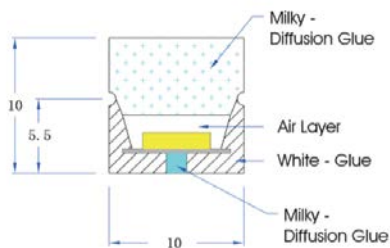

Strip dimension:  
H 10mm x W 10mm

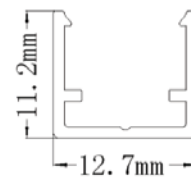

Mounting clip dimension:  
H 12,7mm x W 11,2mm

## IP67 DUAL INJECTION-MOULDED FRONT CAP AND END CAP



Front /End Cap & Cable (IP67)

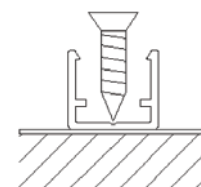

Mounting Clip

**Full set of installation accessories.** (front-end cap, mounting clip and cable). Easy cutting and connection.

## INSTALLATION PROCESS

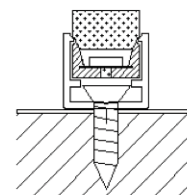
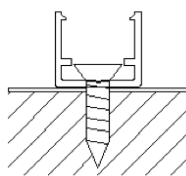
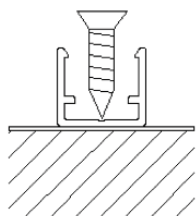

**Step 1.** Put the plastic clip to the installation location.

**Step 2.** Use the electric screw driver to fix the plastic clip onto the surface.

**Step 3.** Insert the Neon LED strip into the plastic clip softly.

## CIRCUIT DIAGRAM

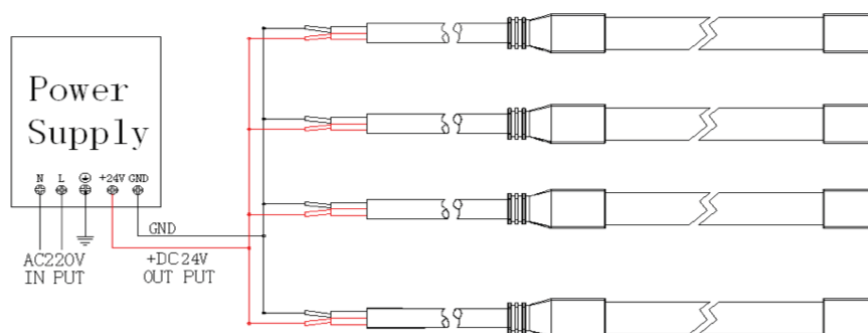

## ALUMINUM PROFILE

Installation aluminum profile as optional accessory, screws can be ordered as needed.

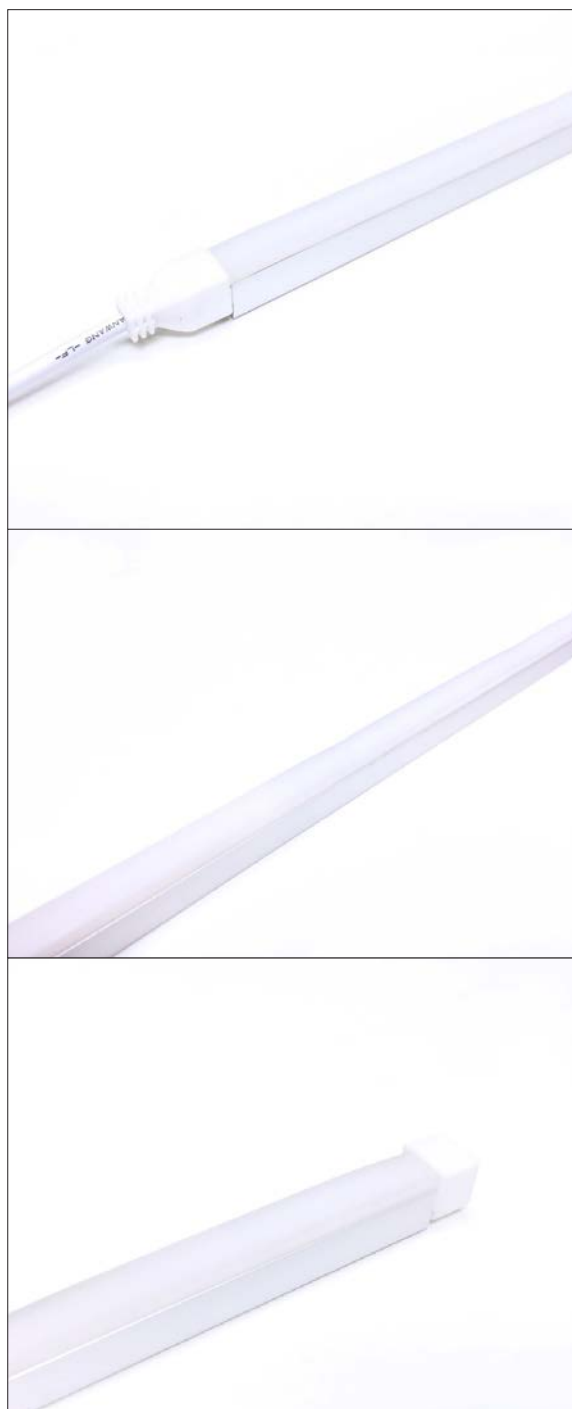
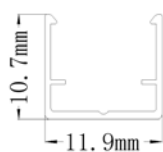

## CONNECTING PROCEDURE

### 1) Strip-to-Wire connector installation:

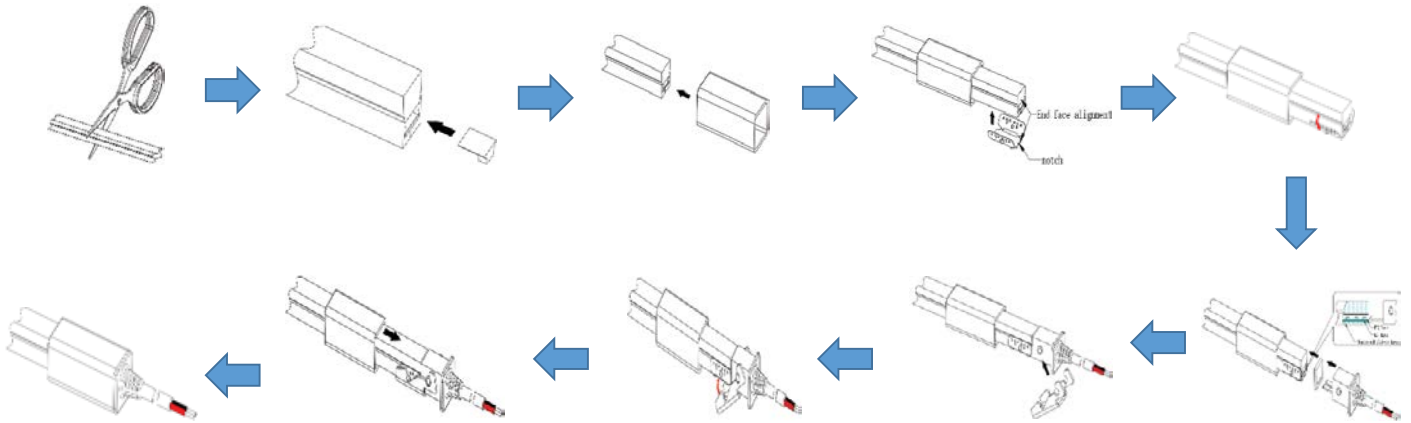

### 2) Strip-to-Strip connector installation:

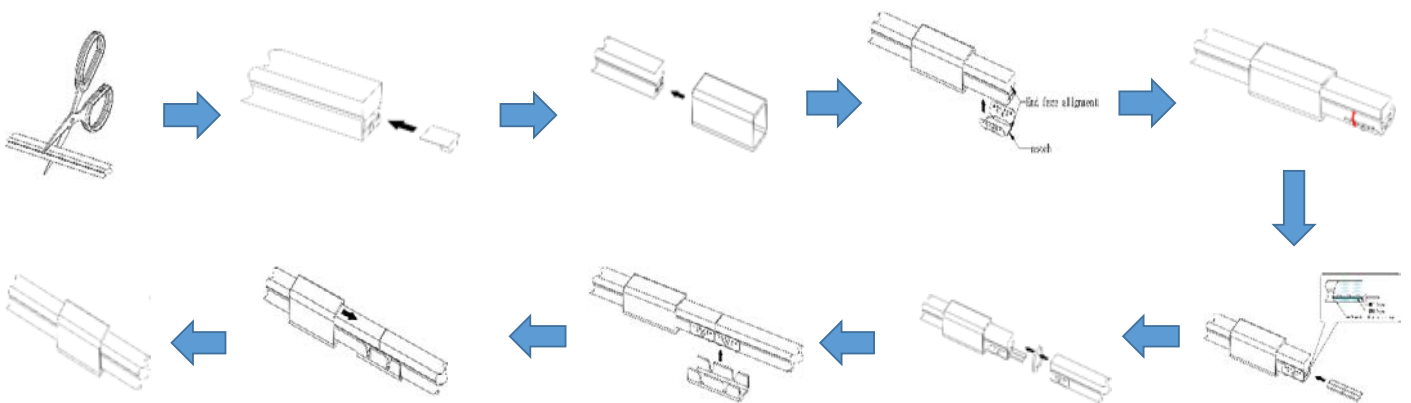

### 3) End-Cap installation:

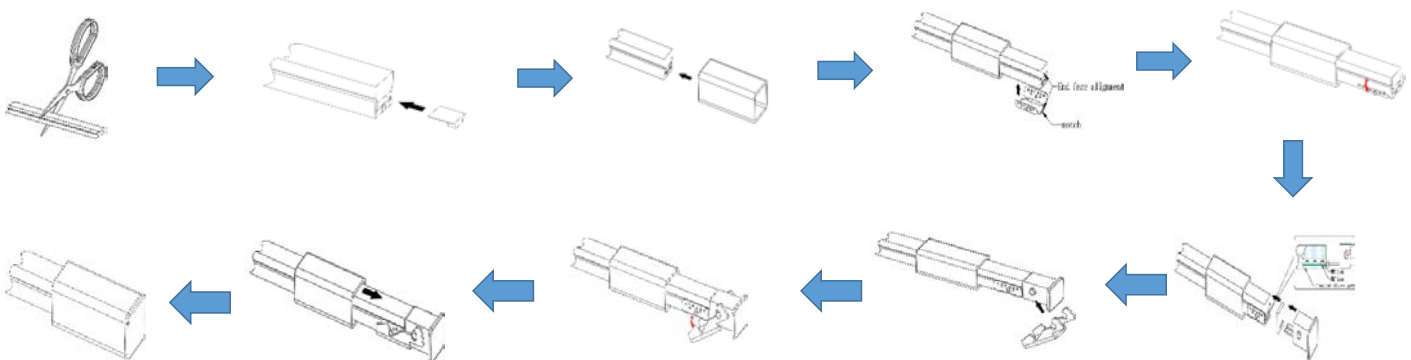

## EASY SELF-CUTTING AND CONNECTION PROCESS

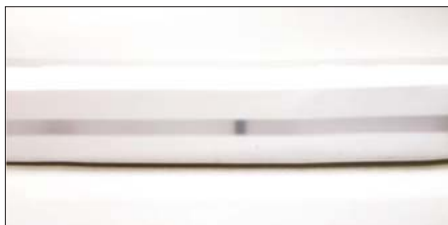

**Step 1.** Find the cutting line mark.



**Step 2.** Split the strip along the cutting mark by knife.

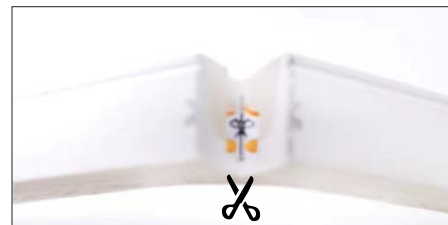

**Step 3.** Cut the PCB along the cutting mark inside the strip by scissors .

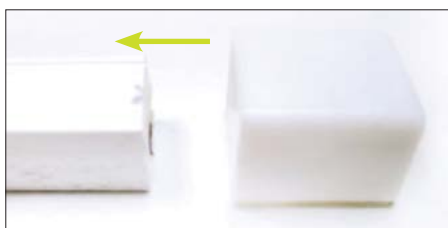

**Step 4.** Fix the strip end into end cap.

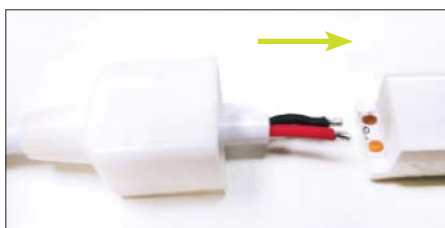

**Step 5.** Solder the cable onto PCB and connect the strip front and front cap.



**Step 6.** Use silicone glue to adhere end cap and front cap.

## STRIP LED DOT FREE ACCESSORIES

### "P" Type

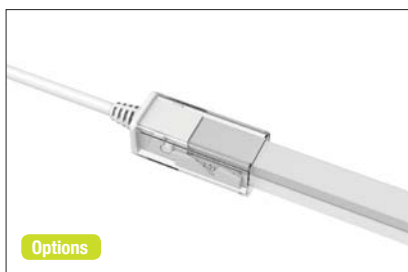

**Dot Free Type "P" 10mm Strip To Wire Connector**  
3ILDFPSTWC10



**Dot Free Type "P" 10mm End Cap Connector**  
3ILDPECC10

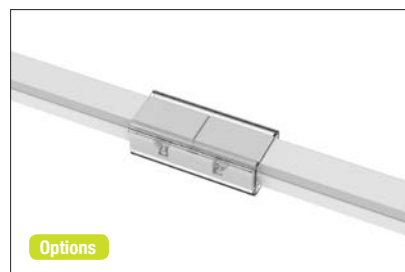

**Dot Free Type "P" Strip To Strip Connector**  
3ILDFPSTSC10

### Profile



**Moldable Profile**  
10mm "P" Type 3ILPLG1110-500 \_ 5000mm Lenght



**Aluminum Profile**  
10mm "P" Type 3ILAP1211-100 \_ 1000mm Lenght



**PC Mounting Clip**  
10mm "P" Type 3ILPC1212-0025 \_ 25mm Lenght